



# HDL106NE Ex e

---

## Floodlight

### HDL106NE Ex e LED

The HDL106NE is a distinctive Emergency luminaire allowing up to six modules interlinked, providing an effective and efficient replacement for conventional high power HID floodlights.

With integral battery backup, allowing for either 90 minutes or 3 hours battery duration, and a variety of beam options available, this is a flexible solution for any Emergency or Escape application.



## Order Details

Type	Version	Voltage Range (V)	Angle of reflected beam	Light color	Cable Entries	Other options
HDL106NE	E – EM (48 LEDs)	H – 100-254V AC	N – Narrow	W – Cool White	0 – M20	04 – RAL 7035 (Grey)
HDL106NE	ES – EM/Std (96 LEDs)	L – 18-54V AC/DC	M – Medium	X – Warm White	5 – M25	
HDL106NE	SES – Std/EM/Std (144 LEDs)		W – Wide			
HDL106NE			X – Extra Wide			

## Technical Details

Light source	LED
Power consumption (W)	48 W, 96 W or 114 W
Voltage Range (V)	100 – 254V AC 50/60Hz
Emergency duration	90 Min (100%) or 3 h (50%)
Lumen/Watt	109
Light color	Warm white or cool white
Power factor	> 0.95
Overvoltage protection	4kV line to line, 6kV line to earth
Angle of reflected beam	Narrow, Medium, Wide, Extra Wide
Lifespan (h)	> 80,000 h
Amount of LED	48 EM, 96 EM/h, 144 h/EM/h
Housing material	Aluminium Alloy with epoxy powder finish
Entry	2 x M20 cable entries
Housing colour	RAL 7035 (optional)
Size (LxWxH)	265x194x306 mm
Installation	Stirrup mounting bracket
Driver	Electronic Driver
Additional information	Termination: 3 core 4 mm <sup>2</sup> max. conductor with looping; M8 Hex Head and M6 SKT Head

## Certificate Details

IP Rating	IP66/67
ATEX classification	Group II Category 2 GD
Area classification	Zone 1 and Zone 21 areas to EN 60079-10-1 and EN 60079-10-2 with installation to EN 60079-14
Type of Protection	Ex e mb (Increased Safety, Encapsulation) Ex t (Dust Protected Enclosure)
Certificate (ATEX)	Ex e mb IIC T4 Gb Ex tb IIIC T103°C Db Ta = -20°C bis +50°C
Certificate (IECEX)	IECEX SIR 09.0064X
Certificate (EC)	Sira 09ATEX5159X

## Technical Drawings

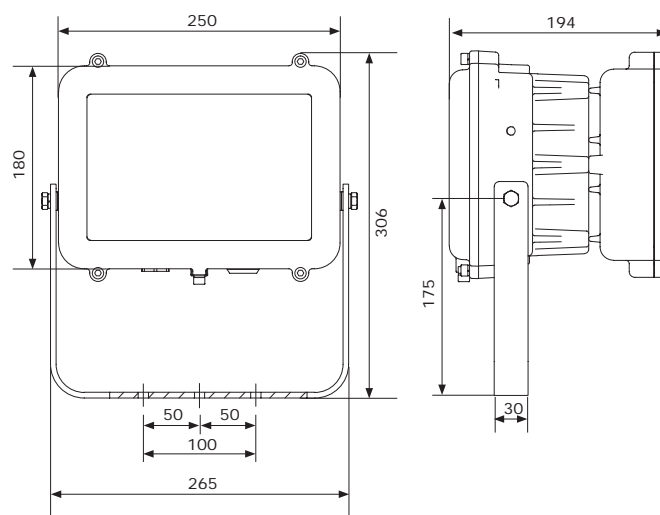

**ISMACON**  
industrial. solution. management. **connected!**

**ISMACON GmbH**  
Albert-Einstein-Straße 10  
48431 Rheine

Tel. +49 5971 95 79 79-0  
Fax +49 5971 95 79 79-9

info@ismacon.com  
www.ismacon.com